

Ventose speciali piane

Special flat suction cups

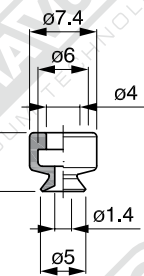

Senza supporto - Without support



art. VSP 5

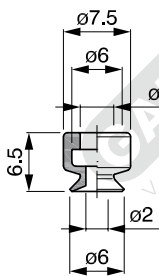

art. VSP 6

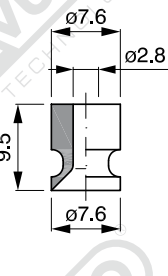

art. VSP 7

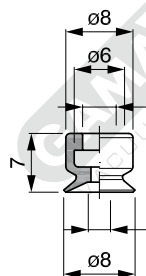

art. VSP 8

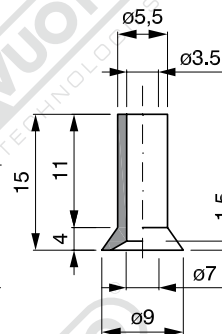

art. VSP 9

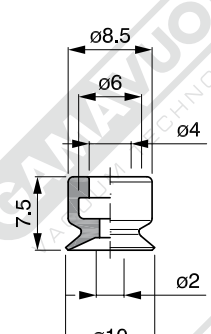

art. VSP 10

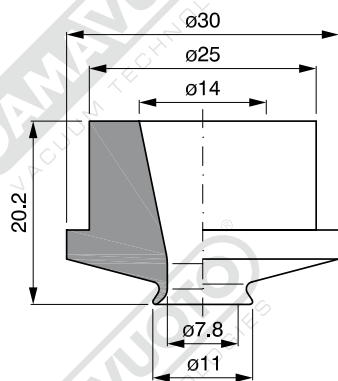

art. VSP 11

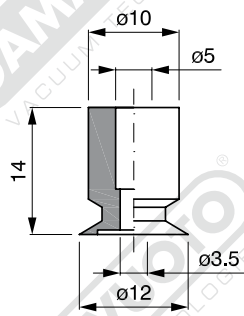

art. VSP 12

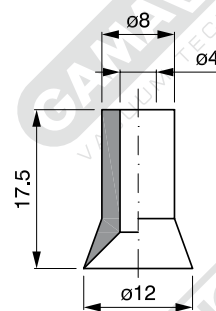

art. VSP 12/1

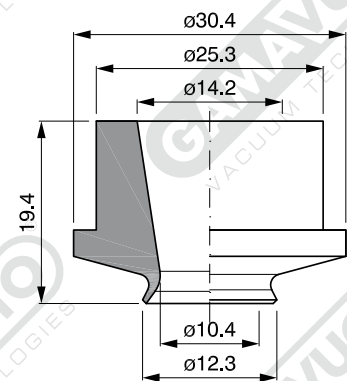

art. VSP 12/2

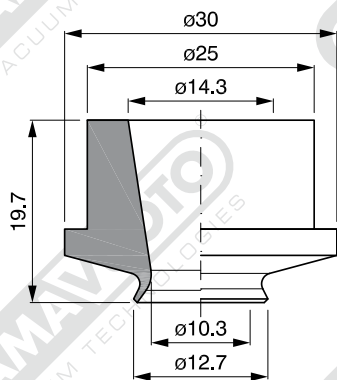

art. VSP 12/3

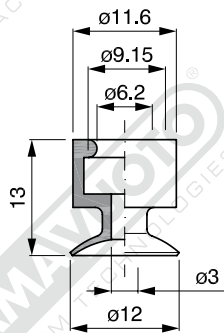

art. VSP 12/4

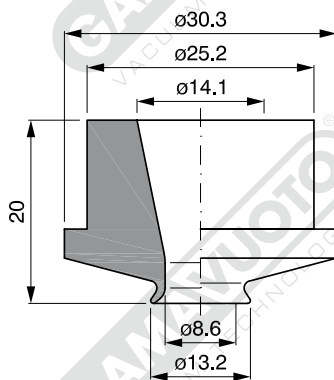

art. VSP 13/1

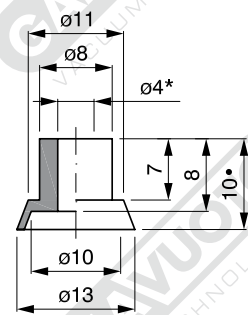

art. VSP 13/41 * = 4 • 11
art. VSP 13/4 * = 4
art. VSP 13/2 * = 2

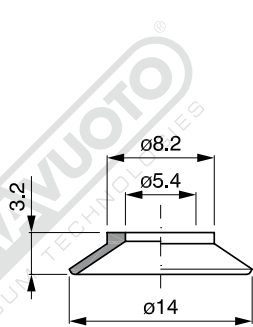

art. VSP 14

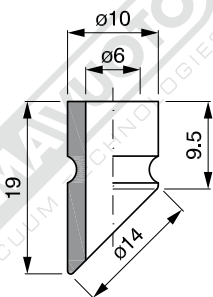

art. VSP 14/1

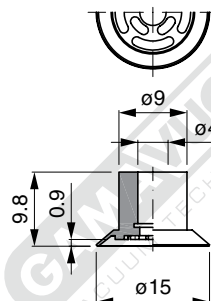

art. VSP 15/L

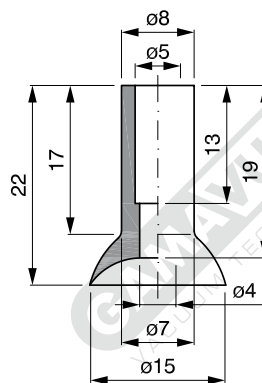

art. VSP 15

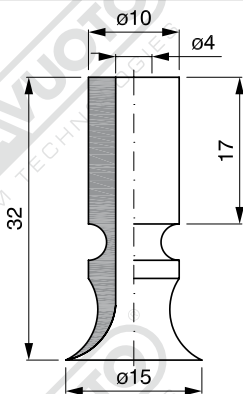

art. VSP 15/1

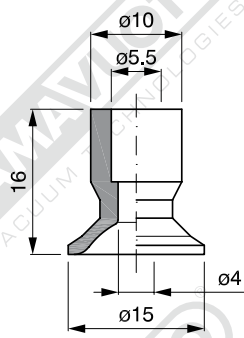

art. VSP 15/2

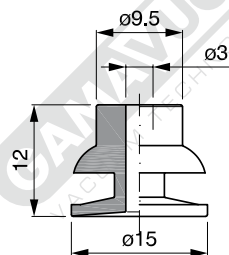

art. VSP 15/3

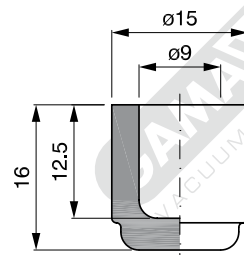

art. VSP 15/4

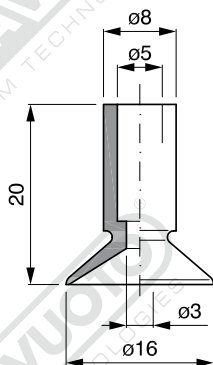

art. VSP 16

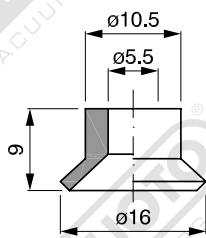

art. VSP 16/1

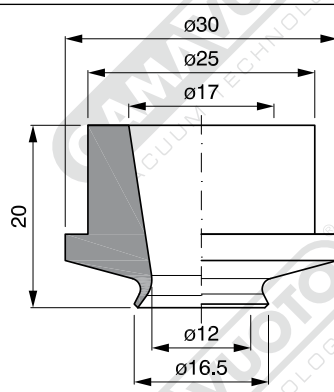

art. VSP 16/2

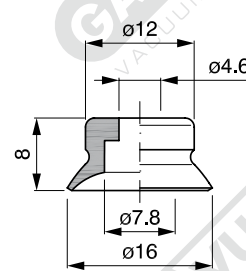

art. VSP 16/3

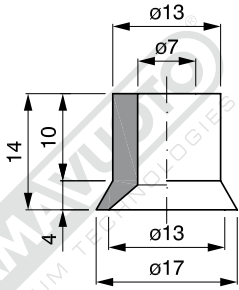

art. VSP 17

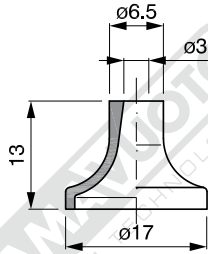

art. VSP 17/1

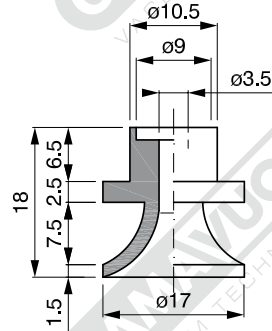

art. VSP 17/2

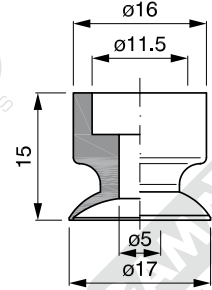

art. VSP 17/3

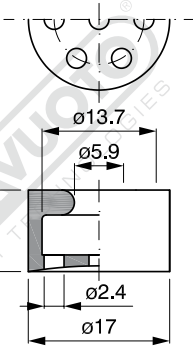

art. VSP 17/4

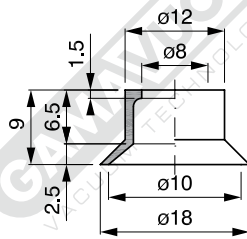

art. VSP 18

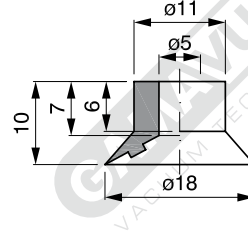

art. VSP 18/1

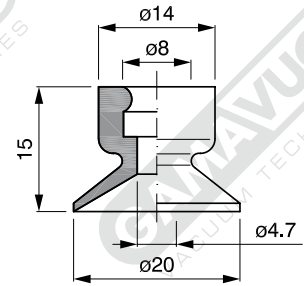

art. VSP 18/2

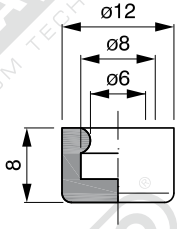

TAP 12x6x8E

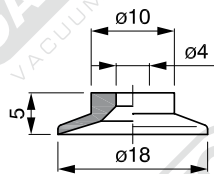

art. VSP 18/3

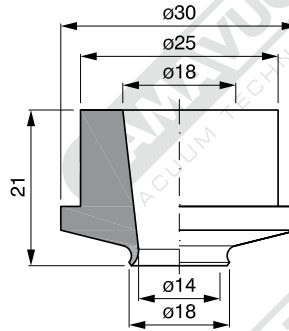

art. VSP 18/4

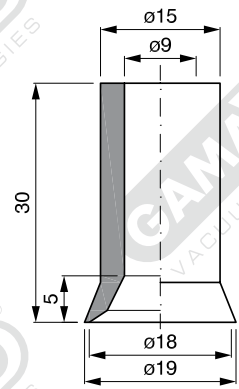

art. VSP 19

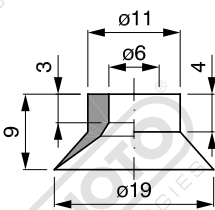

art. VSP 19/1

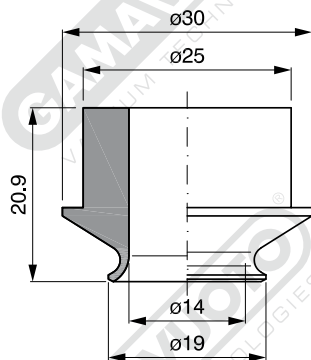

art. VSP 19/2

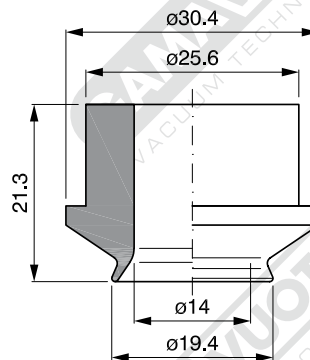

art. VSP 19/3

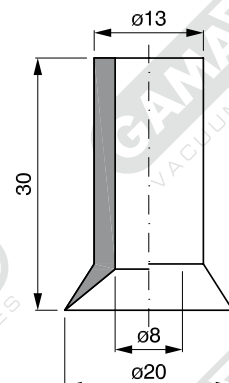

art. VSP 20

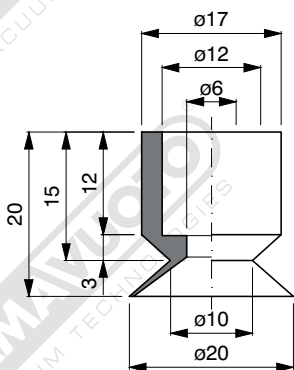

art. VSP 20/1

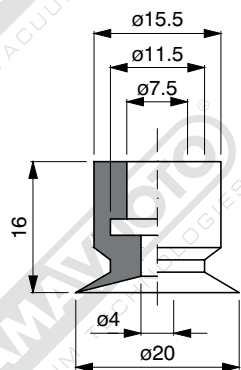

art. VSP 20/2

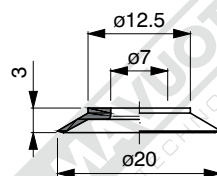

art. VSP 20/3

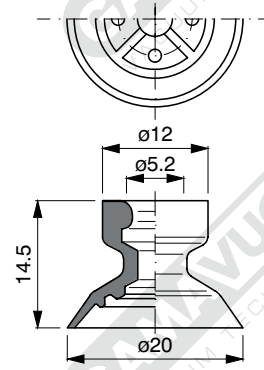

art. VSP 20/4

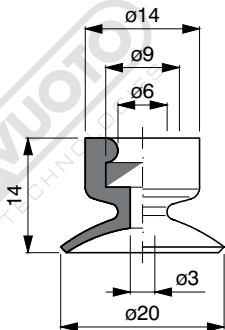

art. VSP 20/5

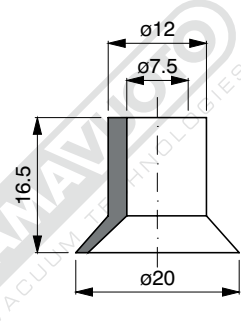

art. VSP 20/6

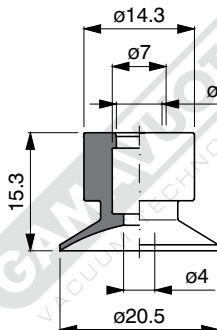

art. VSP 20/7

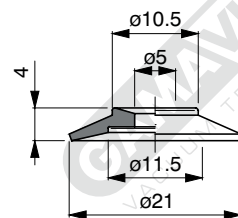

art. VSP 21

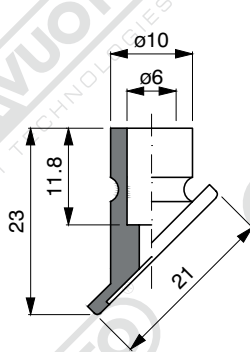

art. VSP 21/1

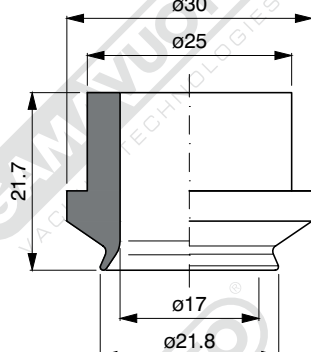

art. VSP 21/2

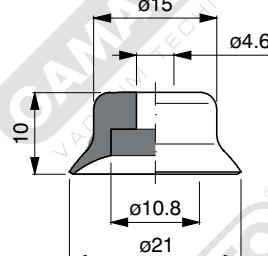

art. VSP 21/3

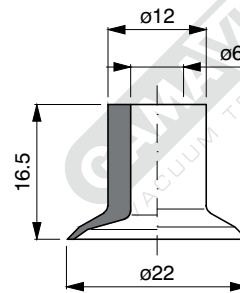

art. VSP 22/1

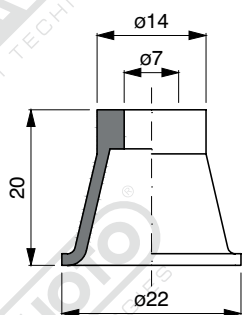

art. VSP 23

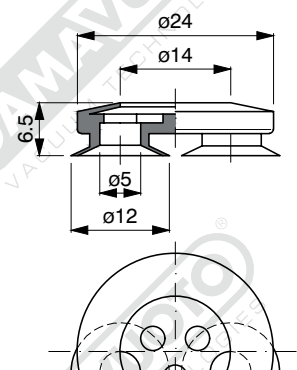

art. VSP 24/2

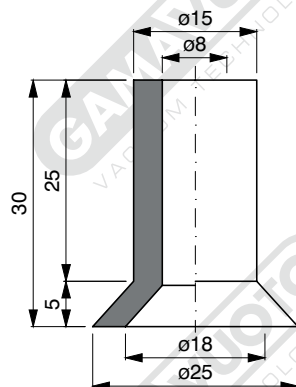

art. VSP 25

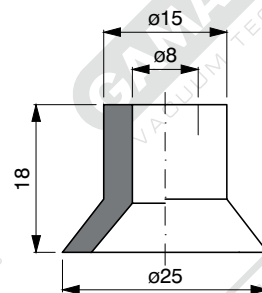

art. VSP 25/1

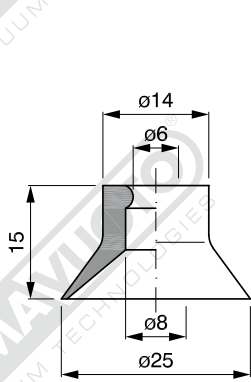

art. VSP 25/2

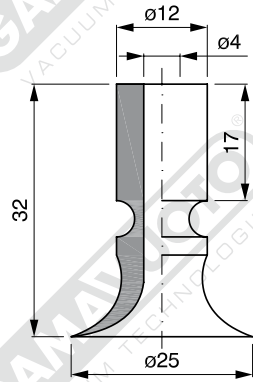

art. VSP 25/3

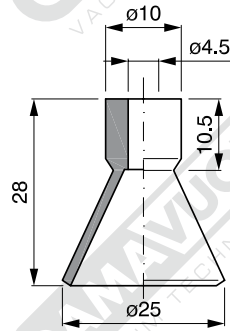

art. VSP 25/4

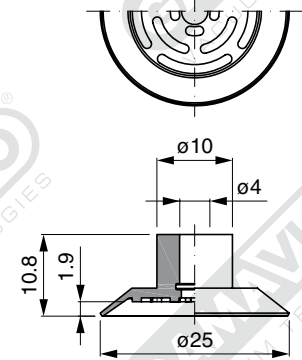

art. VSP 25/L

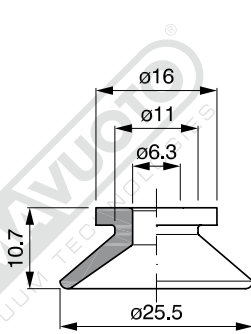

art. VSP 25/6

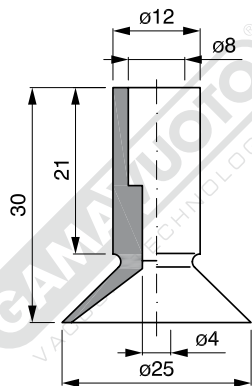

art. VSP 26

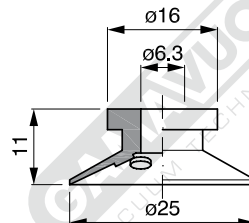

art. VSP 26/1

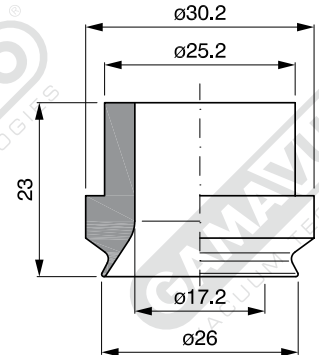

art. VSP 26/2

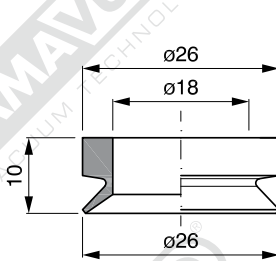

art. VSP 26/3

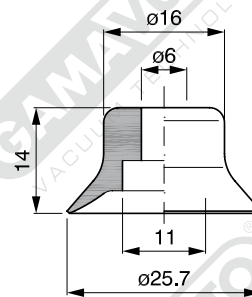

art. VSP 26/4

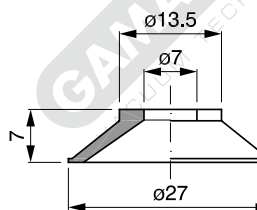

art. VSP 27

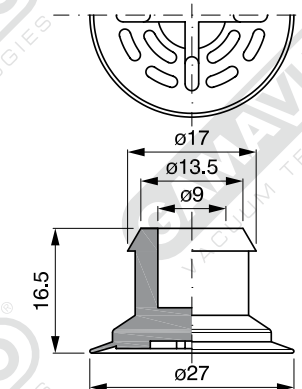

art. VSP 27/1

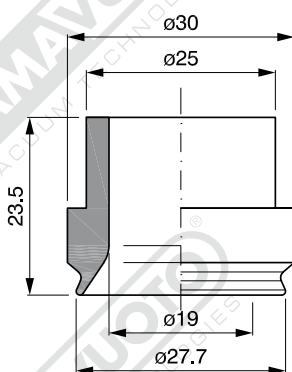

art. VSP 27/2

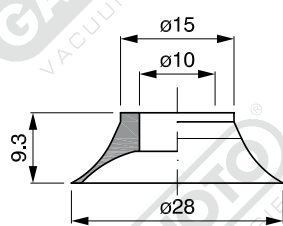

art. VSP 28/1

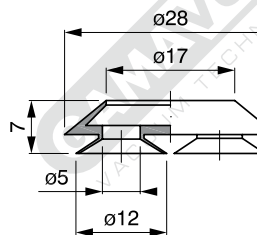

art. VSP 28/2

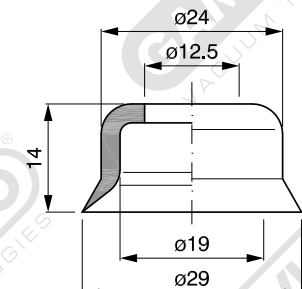

art. VSP 29

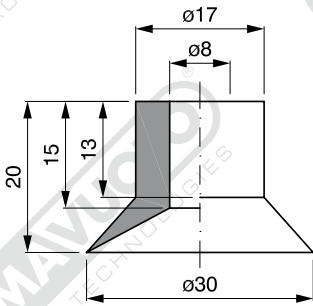

art. VSP 30

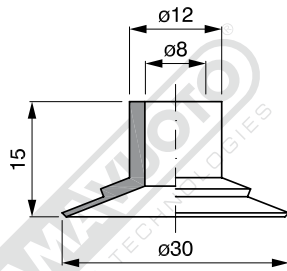

art. VSP 30/1

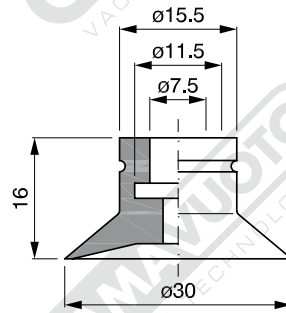

art. VSP 30/2

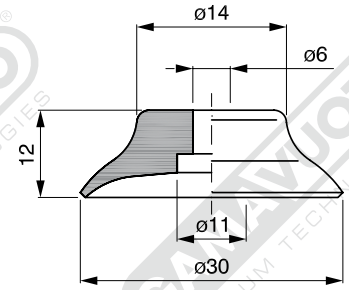

art. VSP 30/3

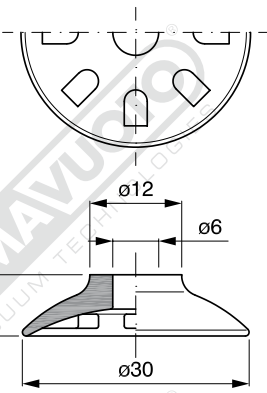

art. VSP 30/4

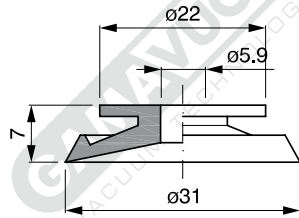

art. VSP 31/1

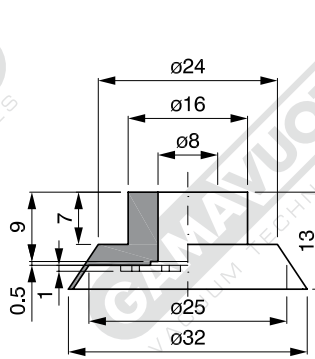

art. VSP 32

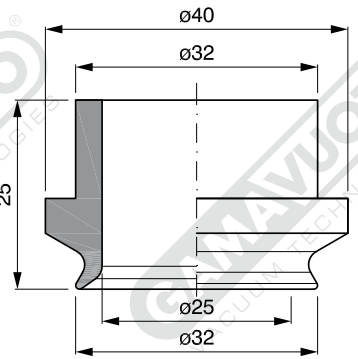

art. VSP 32/1

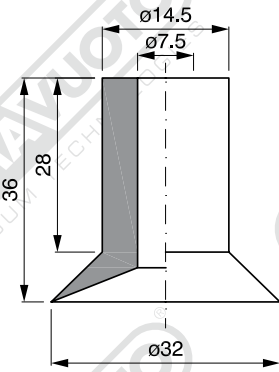

art. VSP 32/2

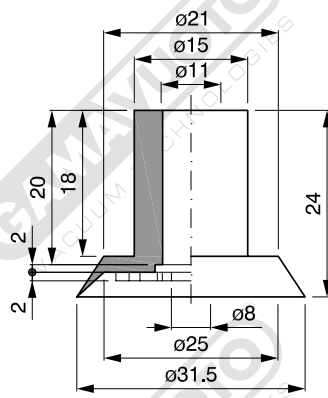

art. VSP 32/L

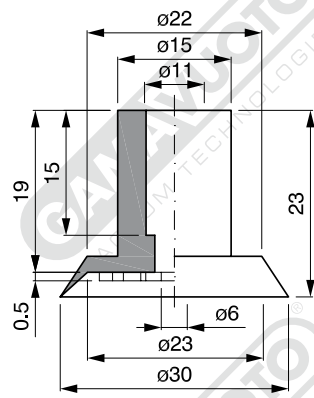

art. VSP 32/L1

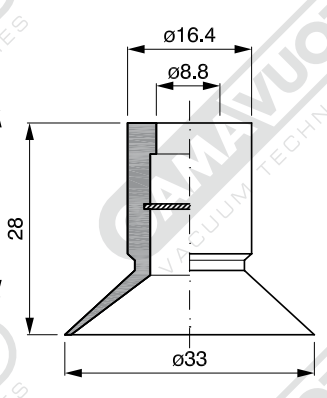

art. VSP 33

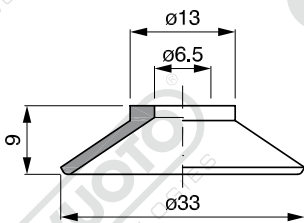

art. VSP 33/1

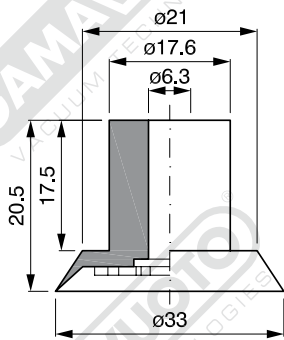

art. VSP 33/2

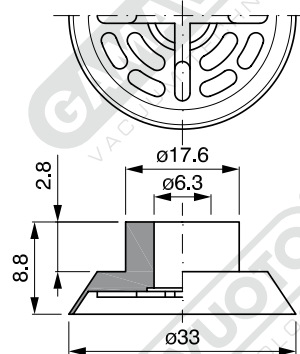

art. VSP 33/3

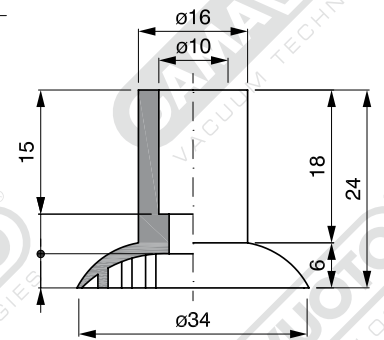

art. VSP 34

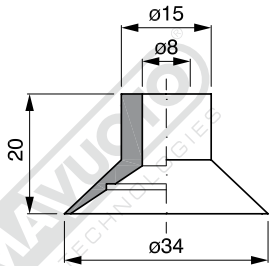

art. VSP 34/A

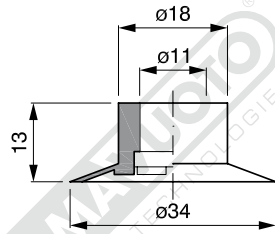

art. VSP 34/1

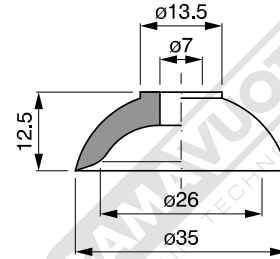

art. VSP 35

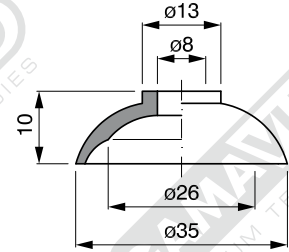

art. VSP 35/A

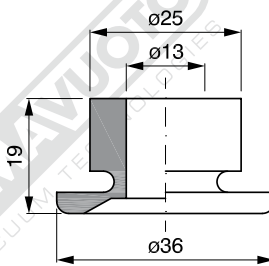

art. VSP 36/1

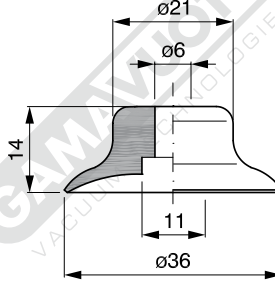

art. VSP 36/2

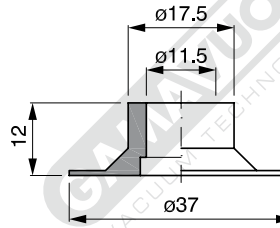

art. VSP 37

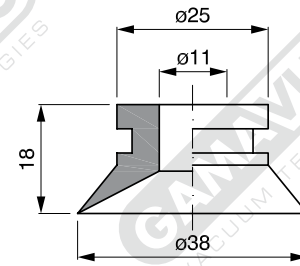

art. VSP 38

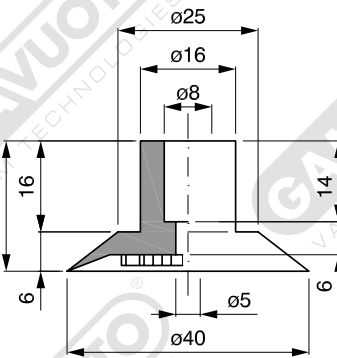

art. VSP 40

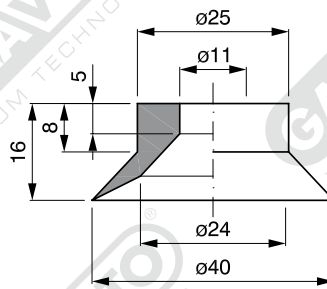

art. VSP 40/1

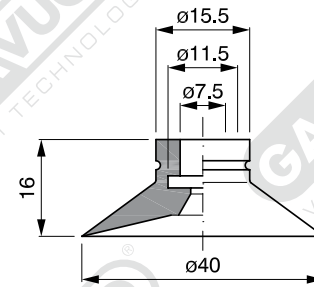

art. VSP 40/2

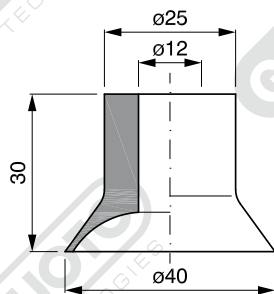

art. VSP 40/3

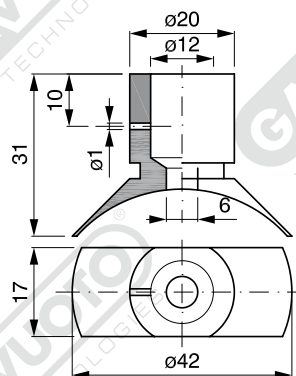

art. VSP 41

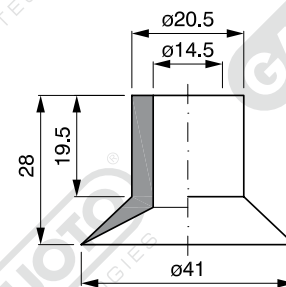

art. VSP 41/1

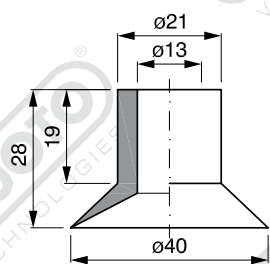

art. VSP 42

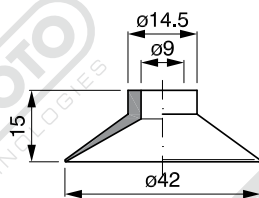

art. VSP 42/1

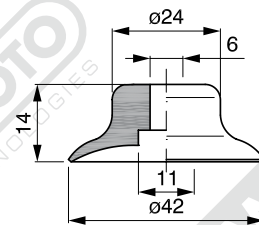

art. VSP 42/3

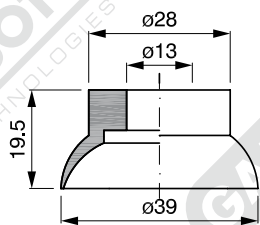

art. VSP 43

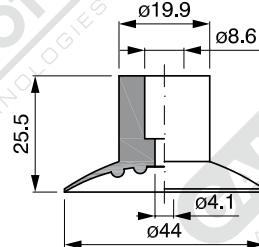

art. VSP 44

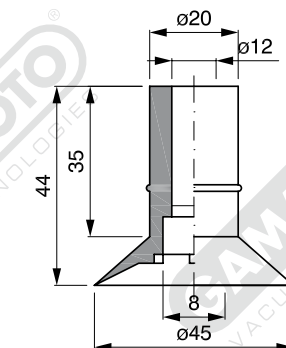

art. VSP 45

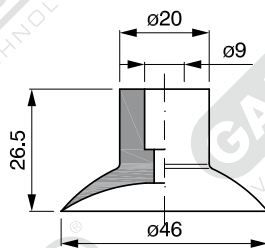

art. VSP 46

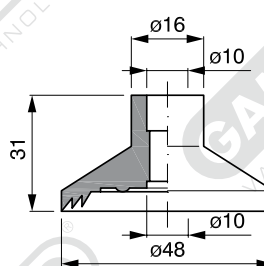

art. VSP 48

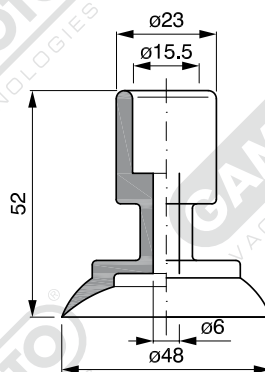

art. VSP 48/1

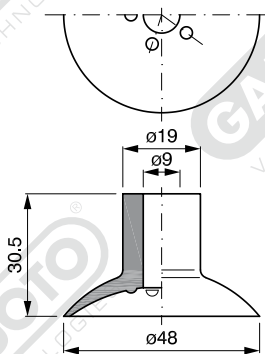

art. VSP 48/2

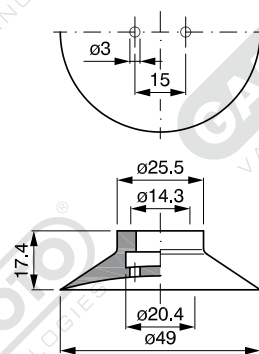

art. VSP 49

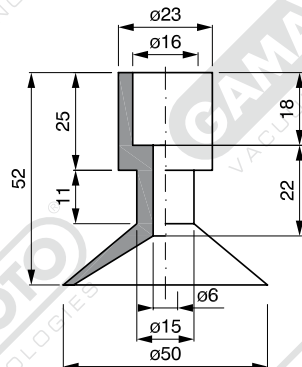

art. VSP 50

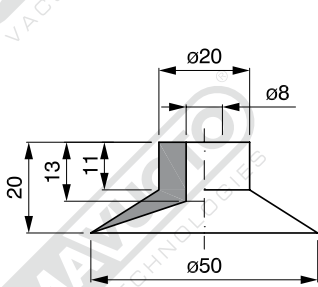

art. VSP 50/1

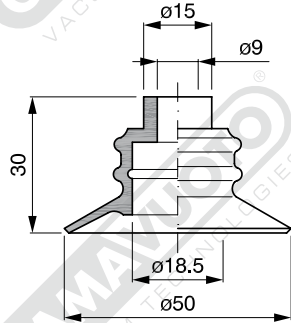

art. VSP 50/2

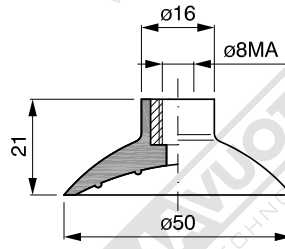

art. VSP 50/3

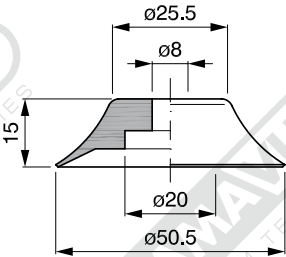

art. VSP 50/4

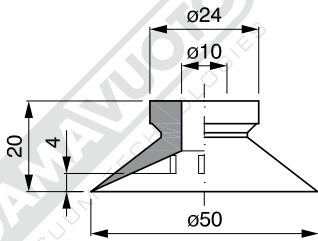

art. VSP 50/8

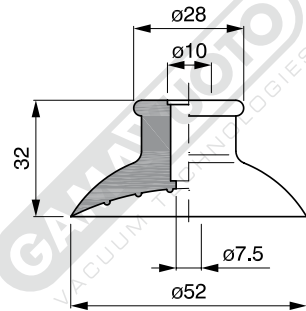

art. VSP 52

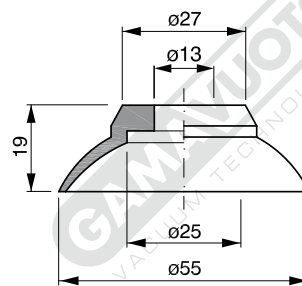

art. VSP 55

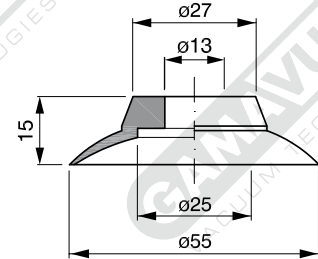

art. VSP 55/1

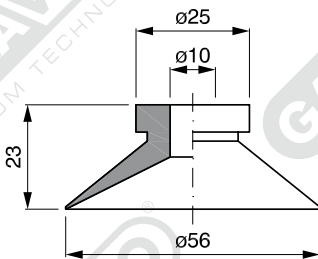

art. VSP 56

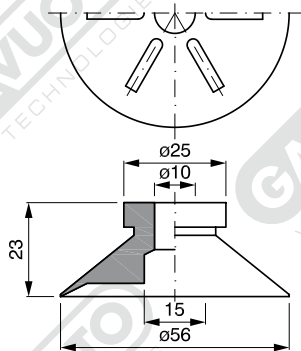

art. VSP 56/8

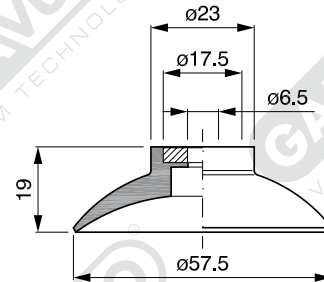

art. VSP 57

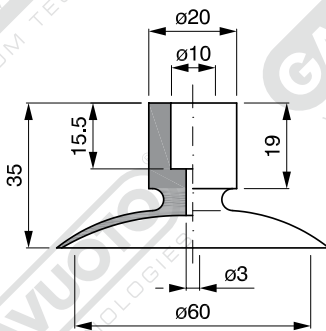

art. VSP 60

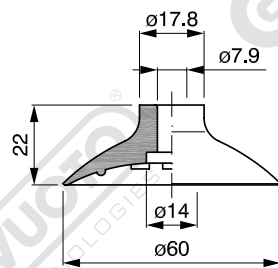

art. VSP 60/1

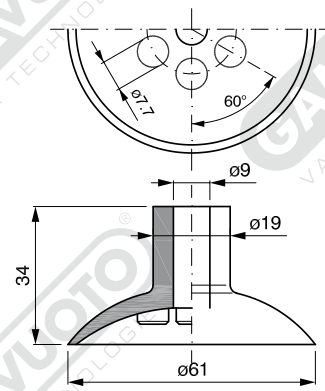

art. VSP 61

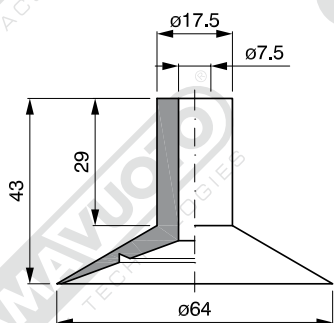

art. VSP 64

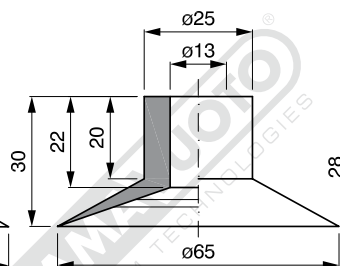

art. VSP 65/1

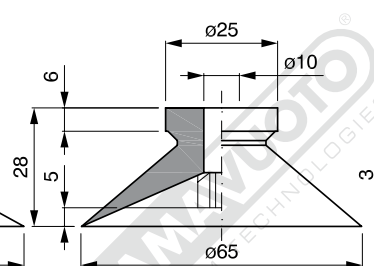

art. VSP 65/8

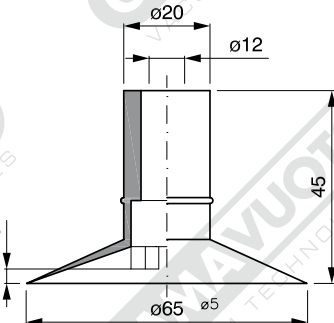

art. VSP 65/8L

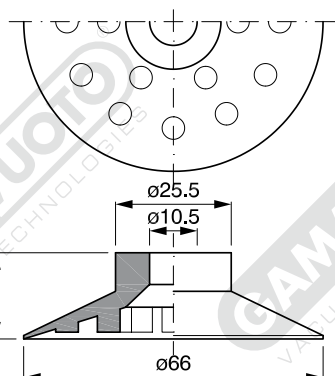

art. VSP 66

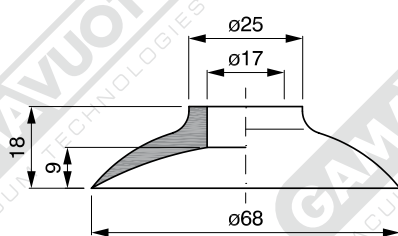

art. VSP 68

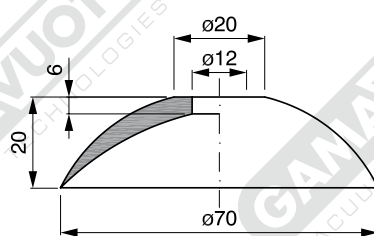

art. VSP 70

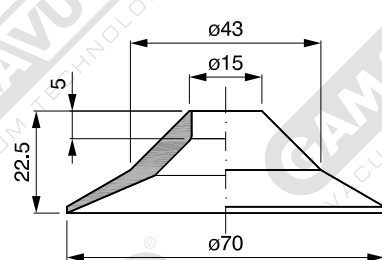

art. VSP 70/1

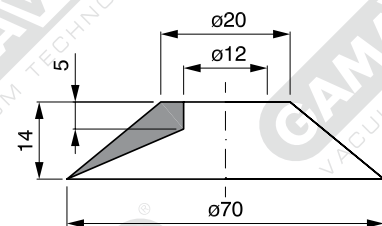

art. VSP 70/2

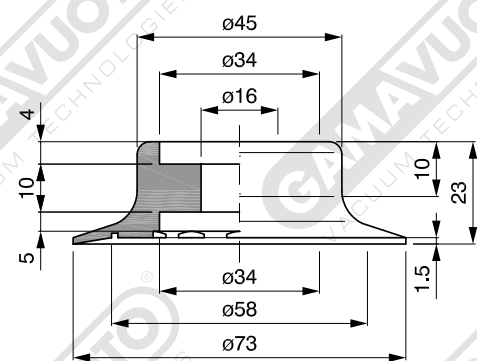

art. VSP 73

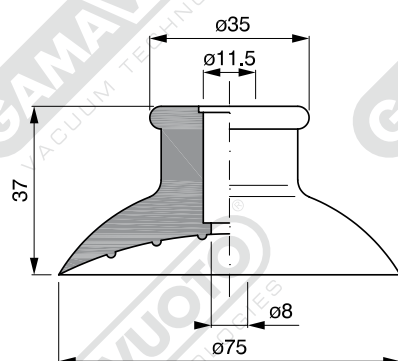

art. VSP 75

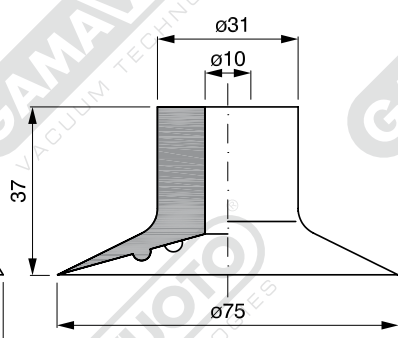

art. VSP 75/1

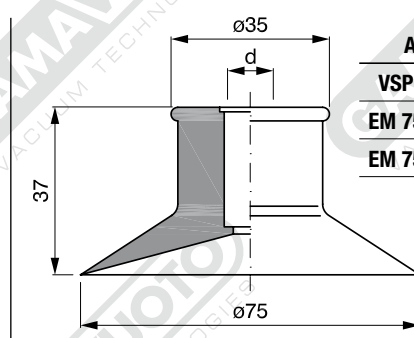

Art.	d
VSP 75/A	11,5
EM 75/A 12	12 MA
EM 75/A 14	1/4"

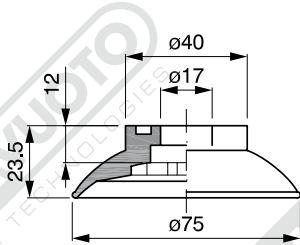

art. VSP 75/3

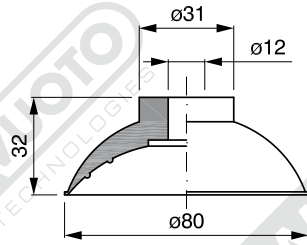

art. VSP 80

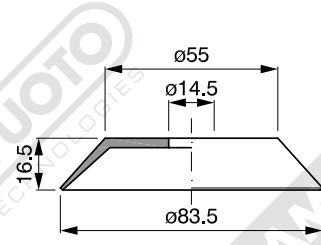

art. VSP 83

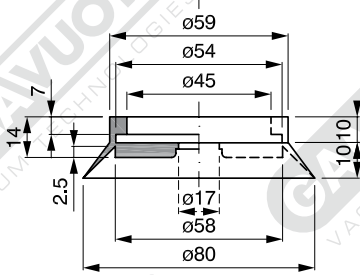
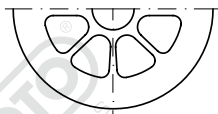

art. VSP 85

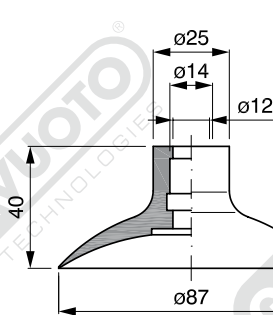

art. VSP 87

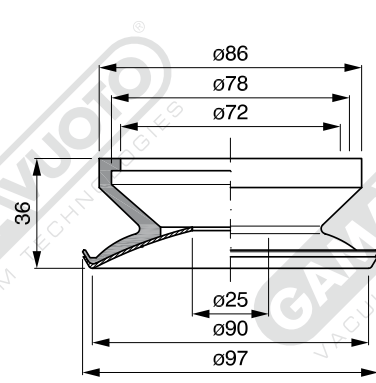

art. VSP 97

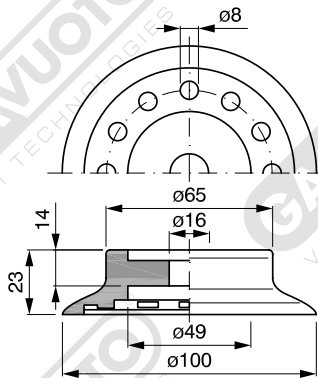

art. VSP 100

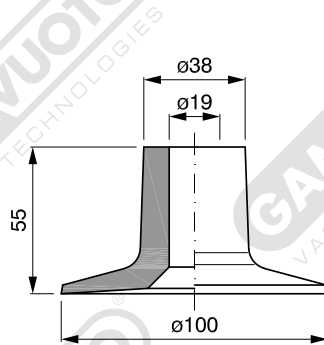

art. VSP 101

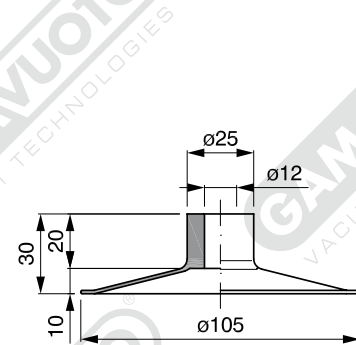

art. VSP 105

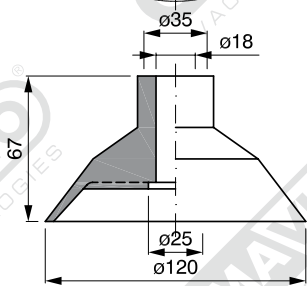
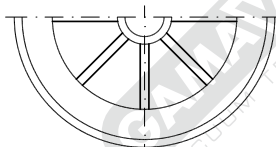

art. VSP 120

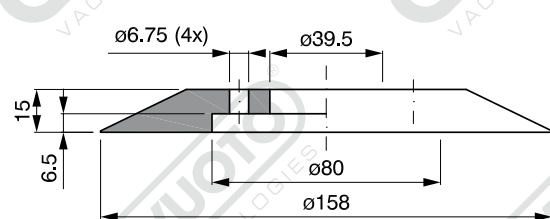

art. VSP 158

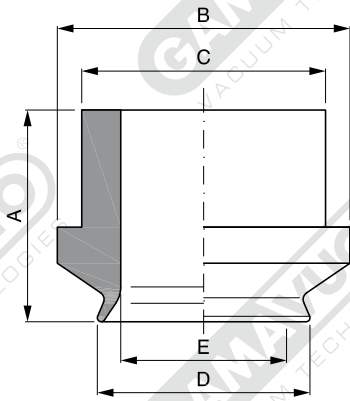

Art.	A	B	C	D	E
VSP 37/1	31	53	44,7	37	29
VSP 45/1	32	53	44,7	45	36,6

VENTOSE
SUCTION CUPS

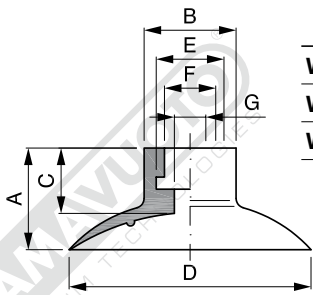

Art.	A	B	C	D	E	F	G
VSP 30/6	17	16	11	30	7	4,7	3
VSP 40/6	16	18,5	9	40	13	10	6
VSP 50/6	21	19	12	50	13	10	6

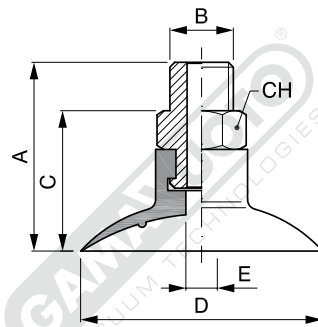

Art.	A	B	C	D	E	CH
VCM 30/6	32,5	1/8	23	30	3	14
VCM 40/6	35	1/4	25	40	6	17
VCM 50/6	39	1/4	29	50	6	17

Ventose speciali piane
con supporto maschio

Special flat suction cups
with male support

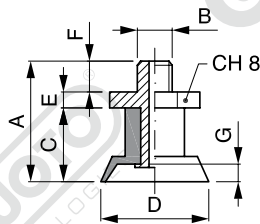

art. EM....

Art =	Ventosa S. cup	+Supporto +Support	Forza Kg Force Kg	A	B	C	DØ	E	F	G
EM 13 02 =	VSP 13/2	+ SUM 46	0,30	17	5 MA	10	13	2	5	2
EM 13 04 =	VSP 13/4	+ SUM 49	0,30	20	5 MA	10	13	4,5	5,5	2

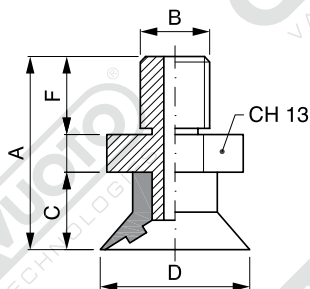

art. EM 18 02

Art =	Ventosa S. cup	+Supporto +Support	Forza Kg Force Kg	A	B	C	DØ	E	F
EM 18 02 =	VSP 18/1	+ SUM 30	0,65	23,5	1/8"	10	18	5	8,5